

Wood Mill Rise

The Dalton 2 bedroom home



Wood Mill Rise

The Dalton 2 bedroom home

Plots as drawn: 9, 57, 59 and 61
 Handed: 10, 58, 60 and 62

71.25 sq.m / 766 sq.ft

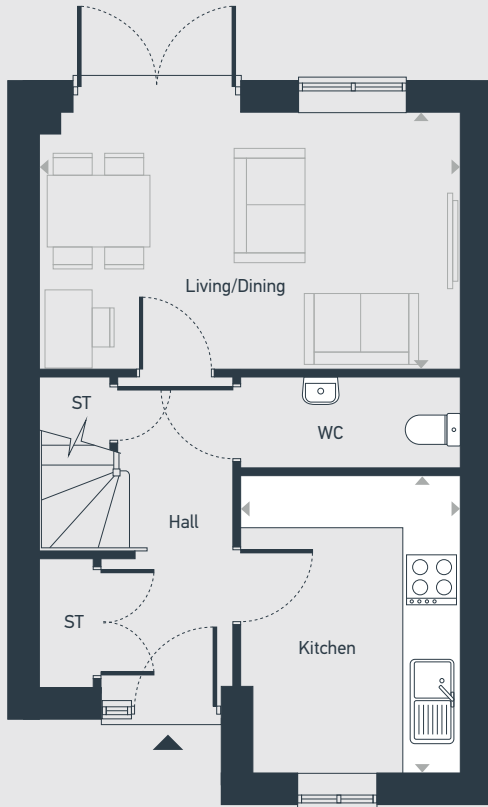

GROUND FLOOR

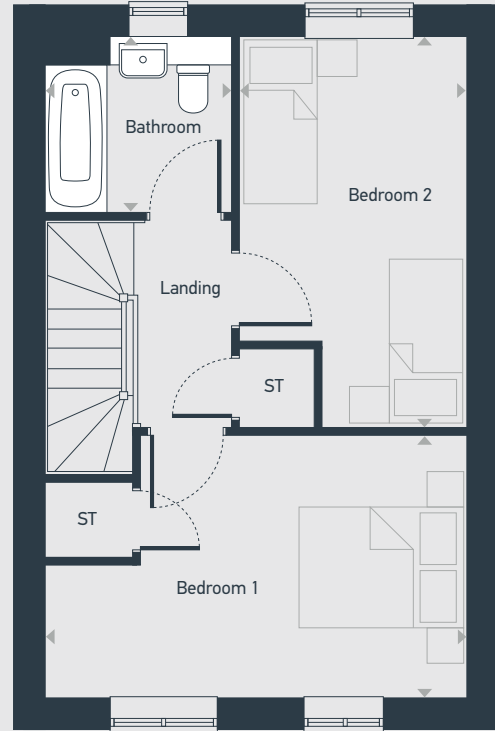

FIRST FLOOR

ST: Store WC: Water Closet

DIMENSIONS	m	ft
Living/Dining	4.85m x 2.95m	15'10" x 9'8"
Kitchen	3.42m x 2.52m	11'2" x 8'3"

DIMENSIONS	m	ft
Bedroom 1	4.16m x 3.02m	13'8" x 9'10"
Bedroom 2	3.13m x 2.61m	10'3" x 8'6"
Bathroom	2.15m x 2.02m	7'0" x 6'7"



01156 710 397 | centralandnorthsales@placesforpeople.co.uk | placesforpeople.co.uk/woodmillrise
 Watch House Lane, Doncaster, DN5 9LZ

Please note: All layouts and floor plans, configurations, maps and information are intended for guidance only and accuracy of this information cannot be relied upon by prospective purchasers who must make their own enquiries to satisfy themselves by inspection or otherwise as to the correct detail.