

Exhall Meadows

The Westbourne 3 bedroom home



Exhall Meadows

The Westbourne 3 bedroom home

Plots as drawn: 5, 21, 36, 52, 67 and 95
Handed: 20, 37, 38, 53, 68, 93 and 94

94.66 sq. m / 1,019 sq. ft

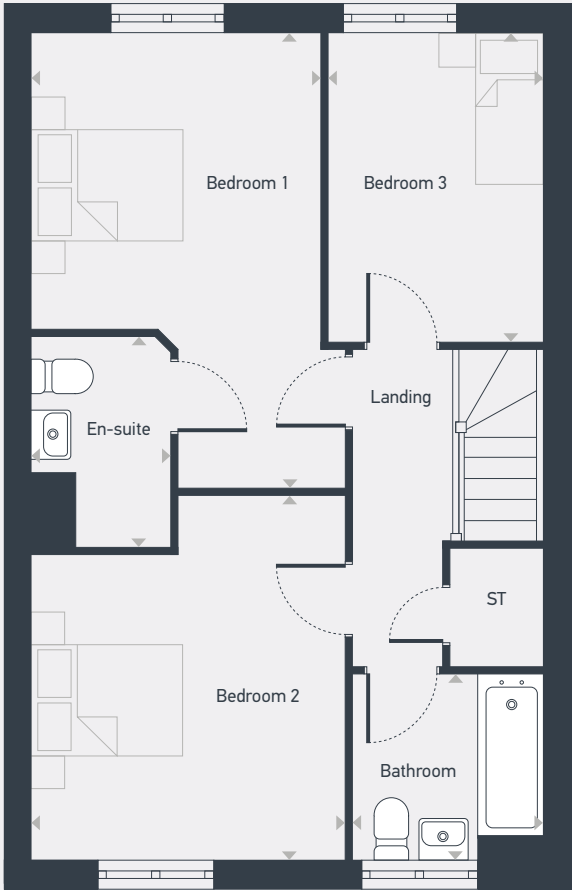
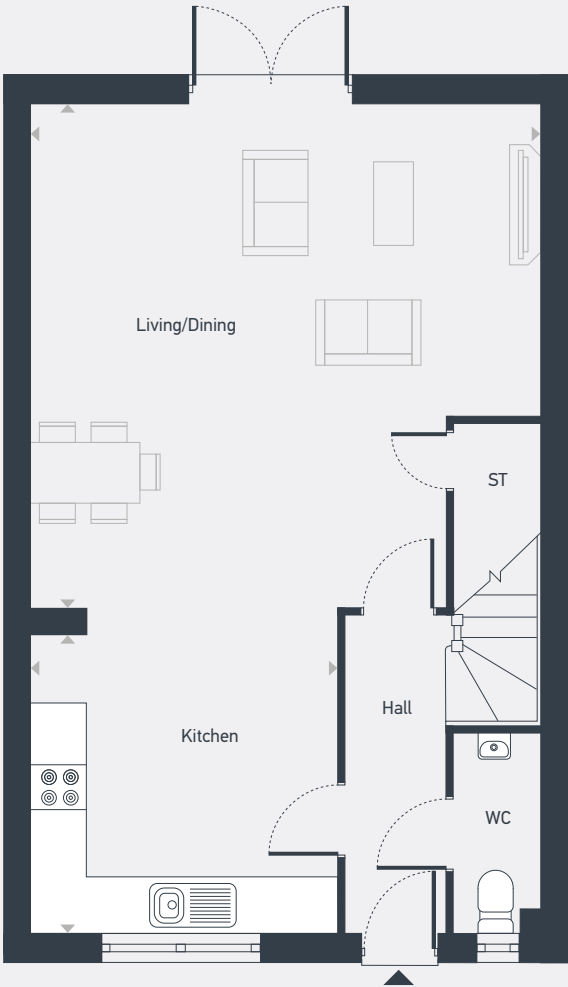

ST: Storage WC: Water Closet

DIMENSIONS	m	ft
Kitchen	3.43m x 3.21m	11'3" x 10'7"
Living/Dining	5.38m x 5.37m	17'8" x 17'7"

DIMENSIONS	m	ft
Bedroom 1	3.19m x 3.00m	10'5" x 9'10"
En-suite	2.17m x 1.38m	7'1" x 4'6"
Bedroom 2	3.82m x 3.28m	12'6" x 10'9"
Bedroom 3	3.31m x 2.29m	10'10" x 7'6"
Bathroom	2.01m x 1.94m	6'7" x 6'4"



02476 601669 | radford@bairstowevescountrywide.co.uk | placesforpeople.co.uk/exhallmeadows
78 Jubilee Crescent, COVENTRY, West Midlands CV6 3ET

Please note: All layouts and floor plans, configurations, maps and information are intended for guidance only and accuracy of this information cannot be relied upon by prospective purchasers who must make their own enquiries to satisfy themselves by inspection or otherwise as to the correct detail.